

U3L-25SGH

Rim mounted 3-hole bath mixer, super goliath high spout

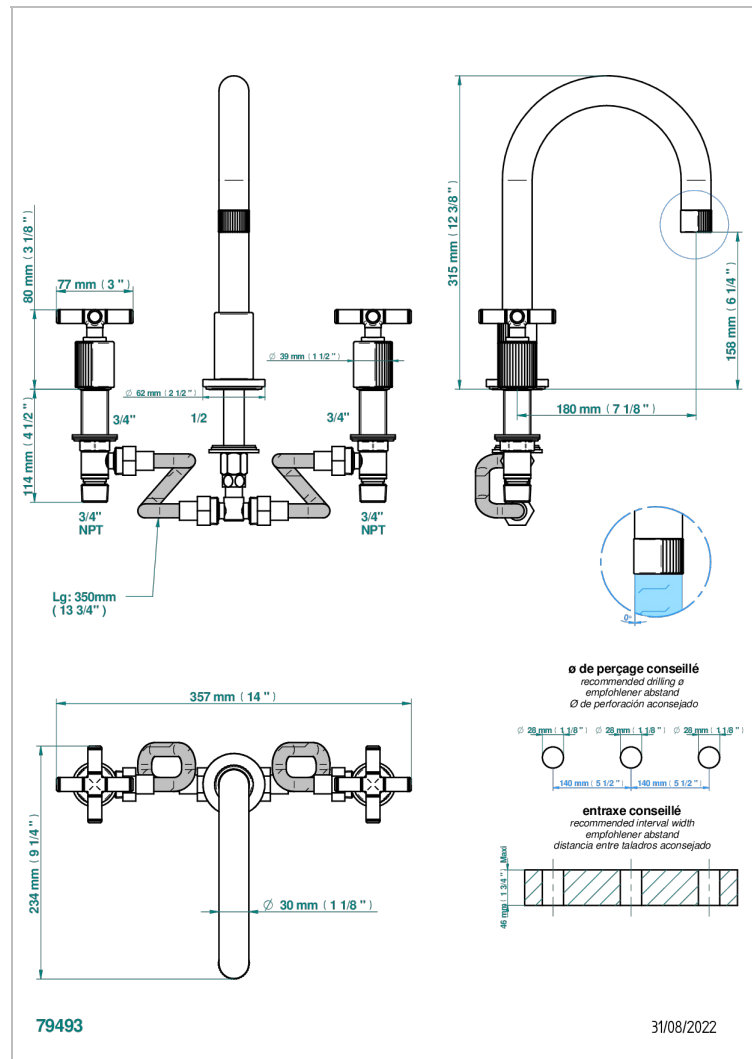

CHARACTERISTIC

- Estrela Metal inlays
- Rim mounted 3-hole bath mixer, super goliath high spout

TECHNICAL SPECS

- Recommandé : 3 bars (max. 5 bars) - Advised : 43,5 psi (max. 72 psi)
- 48 l/min à 3 bars (12.7 gpm at 43.5 psi)

AVAILABLE FINITIONS

Antique nickel - H28	Graphite PVD - H64	Matt gold - F07	Nickel color PVD - H55	Soft matt gold - F31
Black ceram - D30	Matt Umber PVD - H67	Matt gold color PVD - H53	Polished chrome (color finish) - A02	Umber PVD - H66
Blush PVD - H62	Matt bluish PVD - H60	Matt graphite PVD - H65	Polished chrome with gold inlay - GAI	
Brass color PVD - H49	Matt brass color PVD - H50	Matt nickel (color finish) - C01	Polished gold (color finish) - F01	
Brown bronze color PVD - F33	Matt brown bronze color PVD - F34	Matt nickel color PVD - H56	Polished nickel - B01	
Gold color PVD - H52	Matt chrome - C02	Natural smoked Brass - A13	Soft gold - F30	