

CHEVERNY LAPIS LAZULI

A1T-5500BE

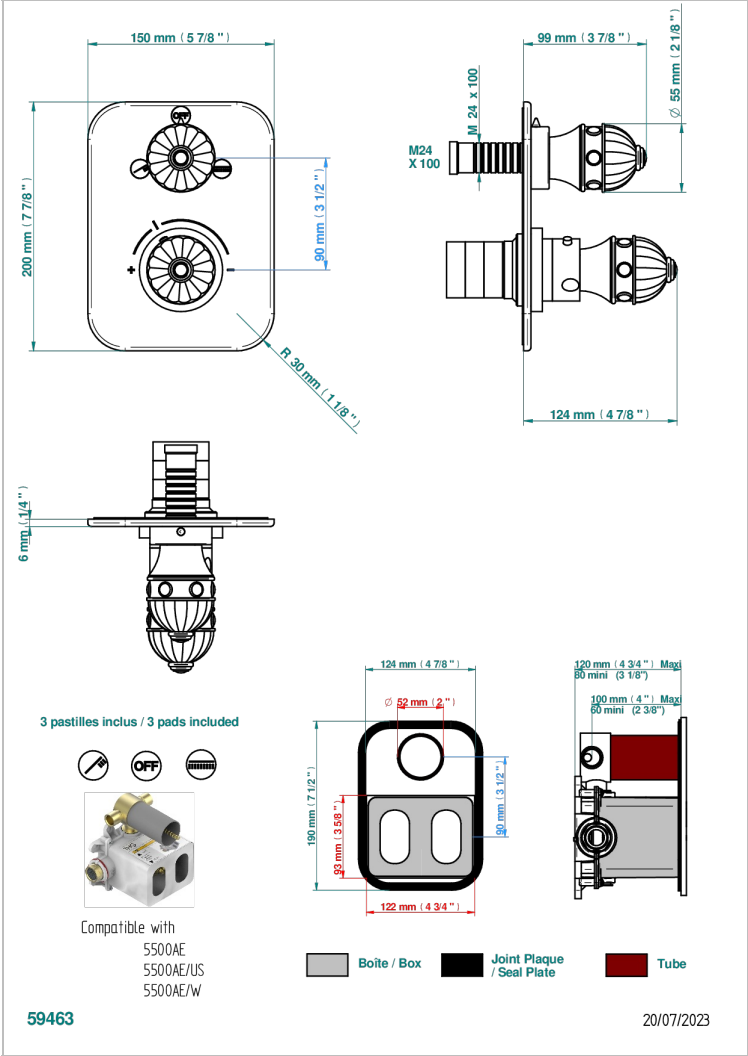

Trim for THG thermostat with 2-way diverter, rough part supplied with fixing box ref. 5 500AE/US



CHARACTERISTIC

- Built-in thermostatic cover for 5500AE - 5500AE/US - 5500AE/W with 2 no.1/2" outputs and 1 stop function
- Requires concealed thermostat Ref 5500AE - 5500AE/US - 5500AE/W
- For Shower 2 functions - non simultaneous -
- Temperature control knob with security stop at 38°C
- Solid brass plate and knob
- ASME : ASME A112.18.1-2011/CSA B125.1-11
- DVGW : DW-6512CQ0608

STANDARDS



RELATED SKU'S

- Ref. G00-5500AE/US 3/4" THG thermostat with 2-way diverter with wax cartridge with stop valve and 2 outlets delivered with a built-in box, no trim
- Ref. G00-5100G Reinforced stop ring for THG thermostatic with fixing set

AVAILABLE FINITIONS

Black ceram - D30	Gold color PVD - H52	Matt brass color PVD - H50	Matt nickel color PVD - H56	Umber PVD - H66
Blush PVD - H62	Gold mat - F07	Matt brown bronze color PVD - F34	Nickel antique / Sovereign - H28	
Brass color PVD - H49	Gold polished - F01	Matt chrome (American satin) - C02	Nickel color PVD - H55	
Brown bronze color PVD - F33	Graphite PVD - H64	Matt gold color PVD - H53	Nickel polished - B01	
Chrome polished - A02	Matt Umber PVD - H67	Matt graphite PVD - H65	Soft gold - F30	
Chrome polished / gold polished - G02	Matt blush PVD - H60	Matt nickel (American satin) - C01	Soft matt gold - F31	