

ø de perçage conseillé
recommended drilling ø
empfohlener Abstand ø
Ø de perforación aconsejado

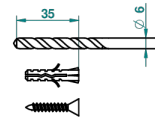
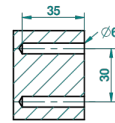

48622

07/02/2013

EIGENSCHAFTEN

- Malmaison, Metall
- Handtuchring

VERFÜGBARE OBERFLÄCHEN

Altnickel - H28
Blassgold - F30
Blassgold matt unlackiert - F31
Bronze hell - D01
Chrom - A02
Chrom / gold - G02

Chrom matt - C02
Gold - F01
Gold matt - F07
Kupfer altrot matt lackiert - H07
Mattschwarz keramik - D30
Nickel matt - C01

Silbernickel - B01