

# AMBOISE RED JASPER

A1L-36

Rim mounted 3/4" valve

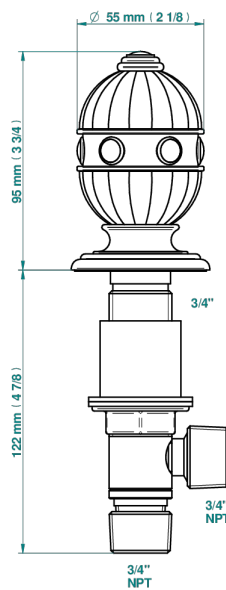

Ø de perçage conseillé  
recommended drilling ø  
empfohlener Abstand  
Ø de perforación aconsejado

Ø 30 mm ( 1 1/8 " )

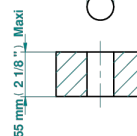

Ø 60 mm ( 2 3/8 " )

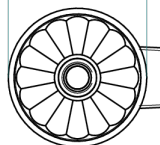

29252

03/04/2024

## CHARACTERISTIC

- Amboise Red Jasper
- Rim mounted 3/4" valve

## AVAILABLE FINITIONS

Antique nickel - H28

Black ceram - D30

Blush PVD - H62

Brass color PVD - H49

Brown bronze color PVD - F33

Gold color PVD - H52

Graphite PVD - H64

Matt Umber PVD - H67

Matt blush PVD - H60

Matt brass color PVD - H50

Matt brown bronze color PVD - F34

Matt chrome - C02

Matt gold - F07

Matt gold color PVD - H53

Matt graphite PVD - H65

Matt nickel (color finish) - C01

Matt nickel color PVD - H56

Nickel color PVD - H55

Polished chrome (color finish) - A02

Polished chrome / Polished gold

(color finish) - G02

Polished gold (color finish) - F01

Polished nickel - B01

Soft gold - F30

Soft matt gold - F31

Umber PVD - H66