

AMOUR DE TRIANON

G24-82V/US

Vertical shower arm & flange ceiling mounted 1/2

THG[®]
PARIS

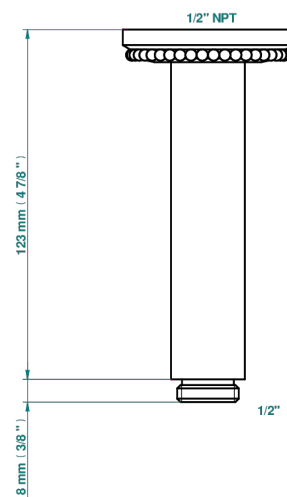
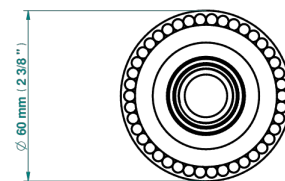
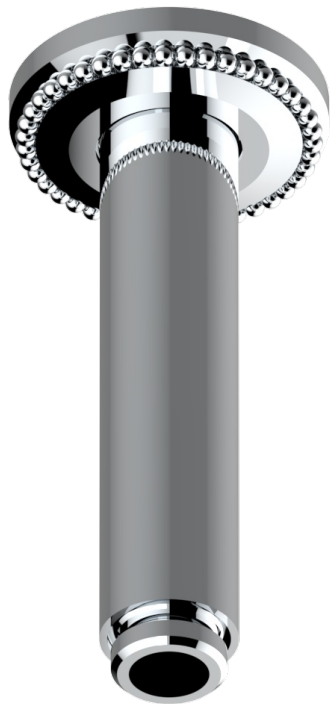

20443

29/04/2022

CARACTERÍSTICAS

- Amour de Trianon
- Vertical shower arm & flange ceiling mounted 1/2

ACABADOS DISPONIBLES

Bronce claro - D01
Cerámica negra mate - D30
Cobre viejo mate - H07
Cromo - A02
Cromo / dorado - G02
Cromo mate - C02

Dorado - F01
Dorado mate - F07
Dorado pálido - F30
Dorado pálido mate (sin barniz) - F31
Níquel - B01
Níquel mate - C01

Níquel viejo - H28